

RS60 EIGHT SLOT BATTERY CHARGER

QUICK START GUIDE

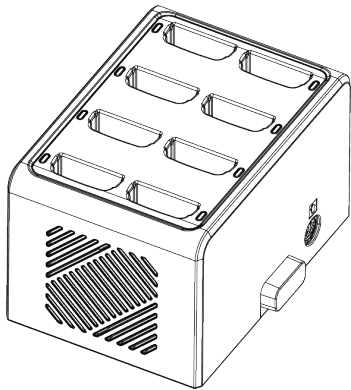

Version 1.0

handheld

OVERVIEW

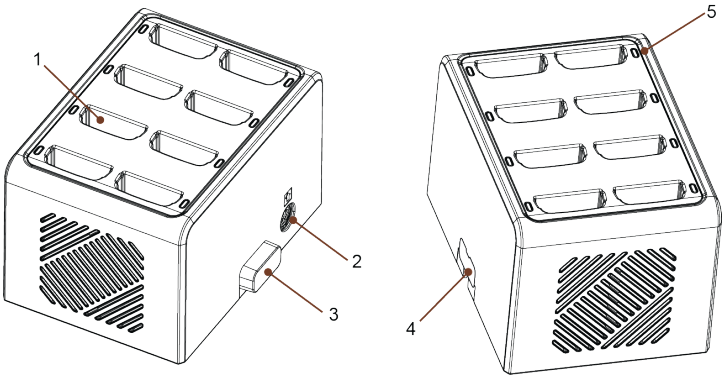

- 1. Battery slot
- 2. Power receptacle
- 3. Cross connection plug with cover

- 4. Cross connection connector with cover
- 5. LED indicator

STANDARD

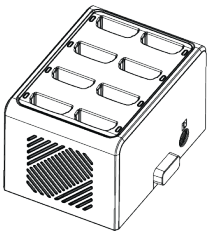

Eight slot battery charger
(HHRS01-1025)

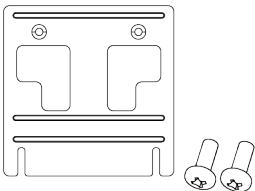

Cross connection bracket & screws

OPTIONAL

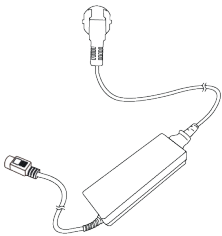

12V 7A adapter & power cable
(HHRS1005+C13 cable)

SUPPLY POWER

- 1. Referring to below figure, connect power cable into power receptacle of the charger as the arrow marks of the cable is facing up (facing arrow mark on the charger)
- 2. Plug the adapter into a power outlet

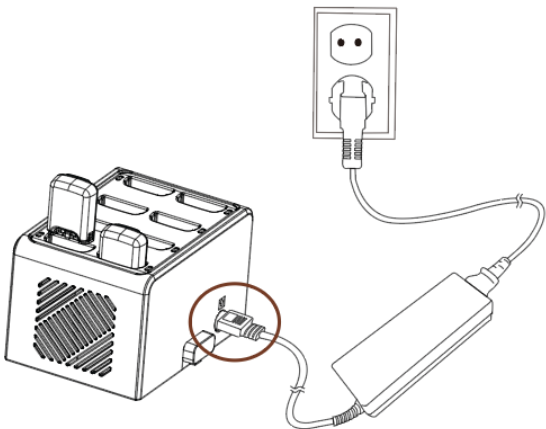

Correct orientation of cable

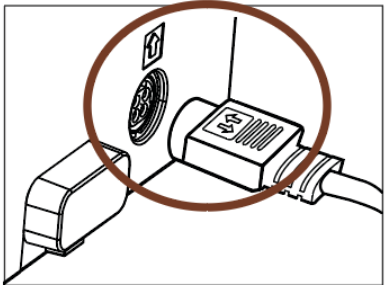

INSERT BATTERY

1. Align the battery as the shape of the slot. Battery connector should be facing down
2. Insert the battery to battery slot until it clicks

When the battery is inserted correctly, the LED indicator next to the slot will light on.
(Red - Charging / Green - Fully Charged)

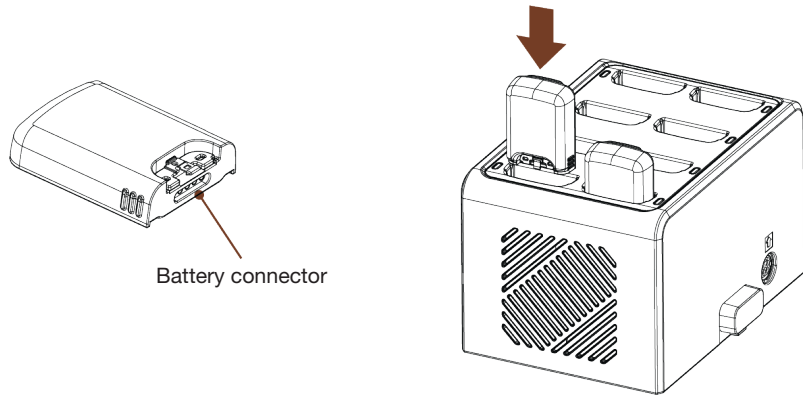

CROSS CONNECTED BATTERY CHARGER 2

3. Turn the charger upside down and insert the bracket referring to below figure.

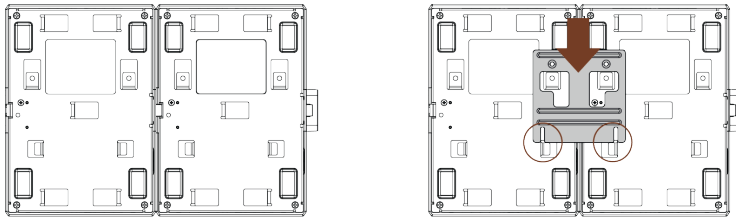

4. Align the bracket's screw holes with the screw holes of the charger and tighten the screws using a screwdriver to fix the chargers in place.

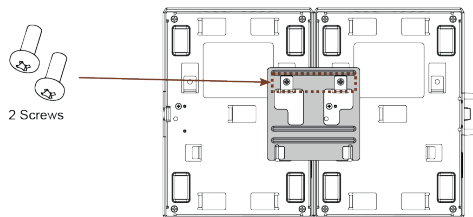

CROSS CONNECTED BATTERY CHARGER 1

HHR01-1025 can be assembled up to 5 pcs for cross connections (HHR01-1015 cross connection is available). Use enclosed bracket and screws. You need a screwdriver.

1. Take off the covers of cross connection plug and connector. Pull out the hole on the bottom side of the cover.

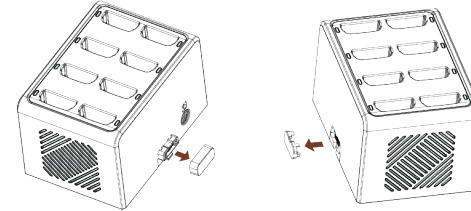

2. Put the cross connection plug into the connector.

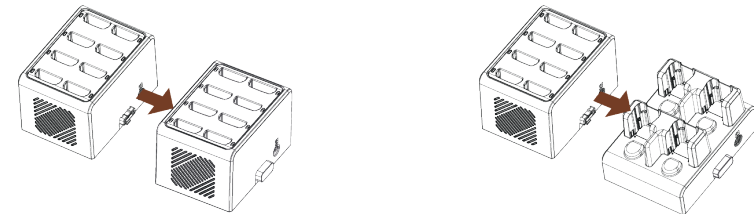

HHR01-1025 + HHR01-1025

HHR01-1025 + HHR01-1015

CROSS CONNECTED BATTERY CHARGER 3

5. If you want to connect more, repeat steps 1 ~ 4.

You can connect up to 5 pcs of chargers in one type only (HHR01-1025 only) or two different types (HHR01-1015 & HHR01-1025).

Power will be provided to all connected chargers when the adapter is connected to the last charger.

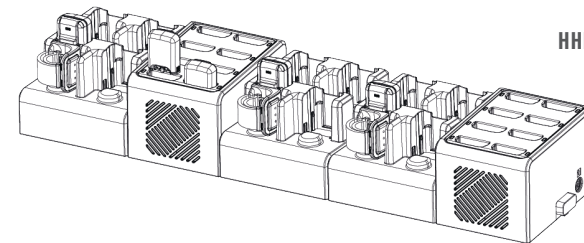

HHR01-1025 + HHR01-1015

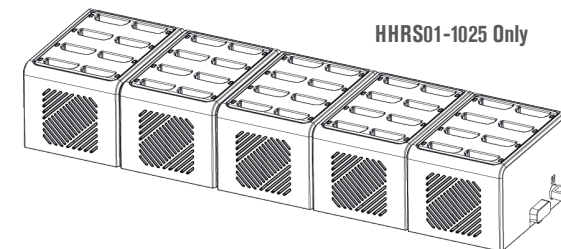

HHR01-1025 Only

